

**NR-25994-C97**  
SHT 1.1

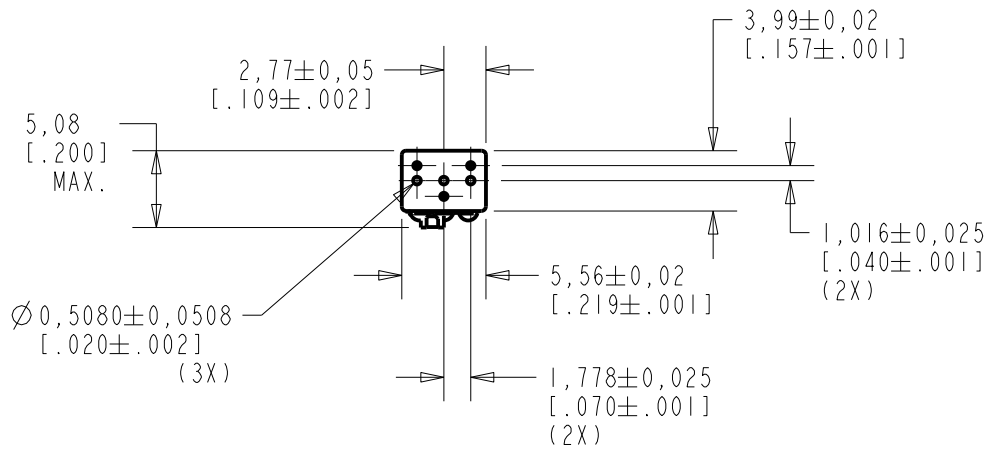

**NOTE:**

1. INCREASED PRESSURE AT THE SOUND INLET CAUSES A POSITIVE GOING VOLTAGE TO APPEAR AT THE OUTPUT TERMINAL, RELATIVE TO THE NEGATIVE TERMINAL.

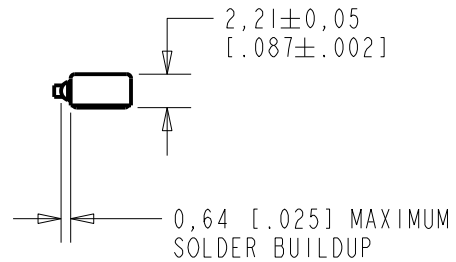
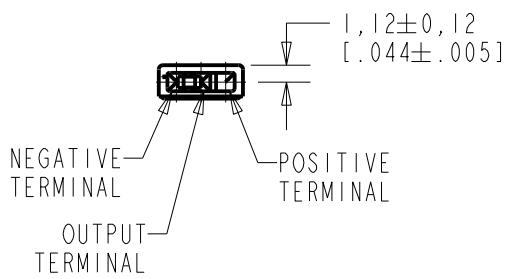

NOMINAL WEIGHT  
.13 GRAM

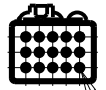

Ø 0.508±0.025  
[.020±.001]  
(15X)

DIMENSIONS IN MILLIMETERS [INCHES]

**KNOWLES ELECTRONICS**  
ITASCA, ILLINOIS U.S.A.

Revision	C.O. #	Implementation Date	RELEASE LEVEL	REVISION
C	MI0104725	7-06-12	<b>Active</b>	<b>C</b>
B	CI0107103	2-22-08		
A	MI0101282	11-20-06		

SCALE: <b>2:1</b>		DR. BY: LSY	DATE: 11-20-06
DO NOT SCALE DRAWING			
TITLE: <b>MICROPHONE</b>		NR-25994-C97	
OUTLINE DRAWING		SHT 1.1	
		APP. BY: GJP	DATE: 11-30-06
		APP. BY: GJP	DATE: 11-30-06

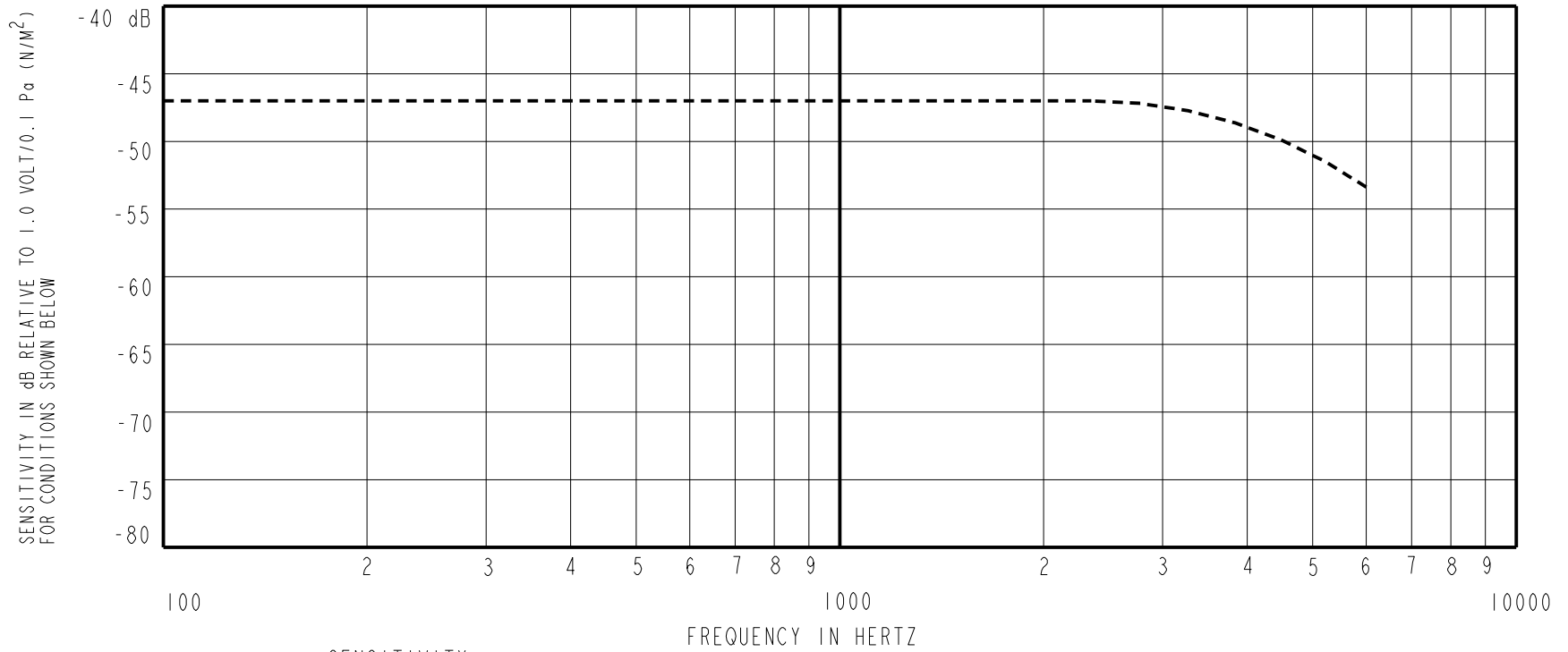

FREQUENCY	SENSITIVITY			DEVICE CONFORMITY	
	MIN.	NOM.	MAX.	RANGE OF DEVIATION FROM 1 KHz	
100	---	-47.0	---	-2.0	+2.0
1000	-50.0	-47.0	-44.0	0.0	0.0
4000	---	-49.0	---	-6.0	+3.0

NOTES:

1. CASE CONNECTED TO NEGATIVE TERMINAL.
2. MICROPHONE TO BE FUNCTIONAL WITH 10 VDC SUPPLY.
3. SENSITIVITY VALUES INDICATED ON THIS SPECIFICATION ARE VALID AT 50% HUMIDITY.
4. PRESSURE DIFFERENCE SENSITIVITY TESTED WITH REAR SOUND PORT SEALED TO AIR VOLUME OF AT LEAST 0.5 CC.

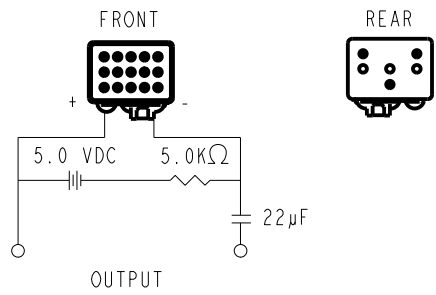

PORT LOCATION	DC SUPPLY	AMPLIFIER CURRENT DRAIN	OUTPUT IMPEDANCE OHMS		
			MIN.	NOM.	MAX.
KA, JA	5.0V	700uA MAX.	2800	4400	6800

Revision	C.O. #	Implementation Date	RELEASE LEVEL	REVISION
C	M10104725	7-06-12	<b>Active</b>	<b>C</b>
B	C10107103	2-22-08		
A	M10101282	11-20-06		

**KNOWLES ELECTRONICS**  
 ITASCA, ILLINOIS U.S.A.

WHEN TEST LIMITS ARE USED TO ESTABLISH INCOMING INSPECTION ACCEPTANCE/REJECTION CRITERIA, CORRELATION OF TEST EQUIPMENT WITH KNOWLES IS ALSO REQUIRED FOR ELIMINATION OF EQUIPMENT AND TEST METHOD VARIATION

TITLE: **MICROPHONE** **NR-25994-C97**  
 PERFORMANCE SPECIFICATION **SHT 2.1**

DR. BY	DATE
LSY	11-20-06
CK. BY	DATE
GJP	11-30-06
APP. BY	DATE
GJP	11-30-06